

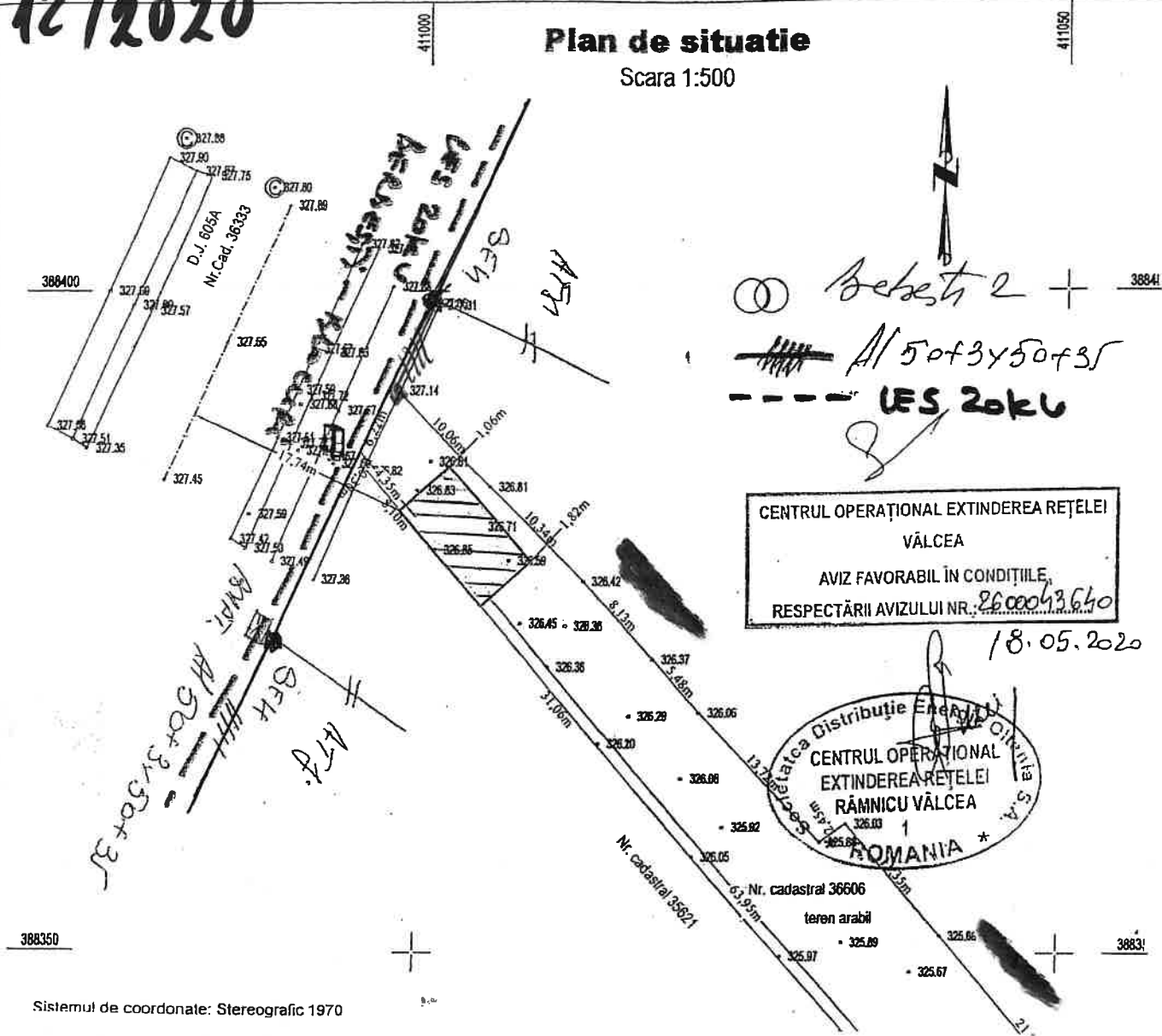





AC 12/2020

48

Plan de situatie

Scara 1:500



-  Amplasament studiat
-  LEA 0,4KV
-  Stalp SE4 existent
-  Cablu ACYy 4x50 propus a se monta
-  FDCS-2T 50A propus a se monta

S.C ELECTRIC GRUP S.R.L.		Beneficiar : _____		Proiect nr:43/2020
		Amplasament:oras Berbesti, str:Dealul Alunis, nr:DJ 605A, - jud. Valcea		
		Aprobat	Ing. Jinaru Ion	Scara
Proiectat	Ing. Jinaru Ion	1:500	Alunisi cu en. electrica-prin traseu trifazat. subteran	CU/AC
Desenat	Paduretu Ion	Data:09	Planșa desenată	Planșa nr. 2
Verificat	Ing. Jinaru Ion	= 2020	Plan de situatie	
Control STAS	Jinaru Maria	VIZAT SPRE NESCHIMBARE		

Anexa la autorizația de construire
desființare

Nr. 12 din 20.10.2020

TEHNICIAN URBANISM AMENAJAREA TERITOFIULUI